

KEW 25 SURFACE  
GLK2WN063

LUMINAIRE REF:

PROJECT REF:



BRONZE RAL 8019

The Kew 25 Surface is a miniature surface mounted IP66 spotlight, ideal for pinpointing landscape ornaments from above or wall grazing for use both inside and out. Our unique, patented wall mounting system allows for quick, tool-free installation on site. The luminaire mounts onto the wall bracket and is self-locking at 15° intervals, preventing the need for further fixing. A discreet, optional tamper proofing feature is available if required for commercial projects. The Kew Surface is IP66 Rated - see FAQs for more details on IP Values.

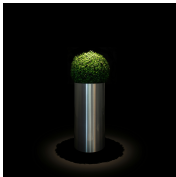
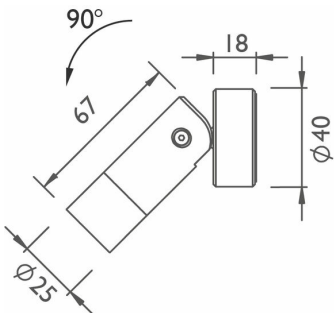

NARROW

ACCESSORIES



IP66 ENCLOSURE  
FOR DRIVER  
LARGE  
ACENIPLRG



IP66 ENCLOSURE  
FOR DRIVER  
SMALL  
ACENIPSML



KEW/HAMPTON  
40 CONDUIT BOX  
ACHK4CB1



KEW 25 CAP  
SNOOT BRONZE  
ACK2CS061



KEW 25 FULL  
SNOOT BRONZE  
ACK2FS061



KEW 25 HALF  
SNOOT BRONZE  
ACK2HS061



KEW 25 SHORT  
SNOOT BRONZE  
ACK2SS061



WWW.JOHN CULLEN LIGHTING.COM

UK +44 (0) 20 7371 9000 | Middle East & APAC +971 (0) 4 321 114 | Europe +33 (0)9 61 68 22 81



KEW 25 SURFACE

GLK2WN063

LUMINAIRE REF:

PROJECT REF:

| SPECIFICATION             | 350mA | 500mA |
|---------------------------|-------|-------|
| BEAM ANGLE (°)            | 11°   | 11°   |
| LED SOURCE LUMENS (LM)    | 101   | 137   |
| LUMINAIRE LUMENS (LM)     | 66    | 94    |
| LUMINAIRE EFFICACY (LM/W) | 66    | 63    |
| INTENSITY RATING (CD)     | 975   | 1349  |
| POWER CONSUMPTION (W)     | 1     | 1.5   |
| DRIVE CURRENT (mA)        | 350   | 500   |
| FORWARD VOLTAGE (V DC)    | 3     | 3     |
| MAX TEMPERATURE (°C)      | 40    | 40    |
|                           |       |       |
|                           |       |       |

|                |  |
|----------------|--|
| INGRESS RATING | IP66                                   |
| IMPACT RATING  | N/A                                    |
| COMPLIANCE     | BS EN IEC 60598-1:2014                 |
|                | IEC 60598-2-7:1982/AMD1:1987/AMD2:1994 |

|                                |                     |
|--------------------------------|---------------------|
| COLOUR TEMPERATURE             | 2700K               |
| CIE CRI AVAILABLE AS           | 98 Ra               |
| IES TM-30 COLOUR FIDELITY (Rf) | 94.3                |
| IES TM-30 COLOUR GAMUT (Rg)    | 98.1                |
| BINNING                        | 2 SDCM (Equivalent) |
| LIFETIME L70/B10 (HOURS)       | >50000              |
| AMBIENT TEMPERATURE (Ta)       | -20 ... +40 °C      |

| ELECTRICAL       |                                    |
|------------------|------------------------------------|
| SOURCE TYPE      | LED                                |
| PRODUCT CLASS    | Class III (SELV low voltage)       |
| DIMMING PROTOCOL | DALI dimmable                      |
|                  | 1-10V dimmable                     |
|                  | Mains dimmable (phase cut dimming) |
|                  | Switched                           |

| OTHER DATA     |                                   |
|----------------|-----------------------------------|
| CABLE TYPE     | 2 Core Silicone (180°C)           |
| CABLE SIZE     | 6.4mm OD - 2 off 24/0.2 (0.75mm2) |
| CABLE LENGTH   | 350mm                             |
| CONNECTOR TYPE | N/A                               |
| WEIGHT         | 55g                               |
| FIRE RATED     | N/A                               |

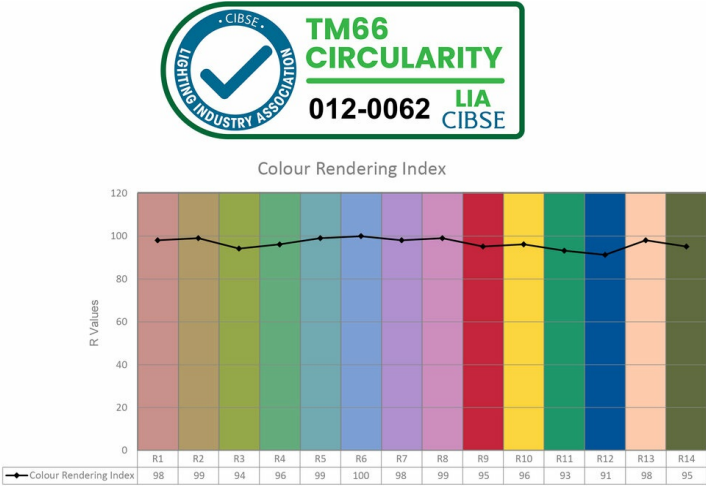
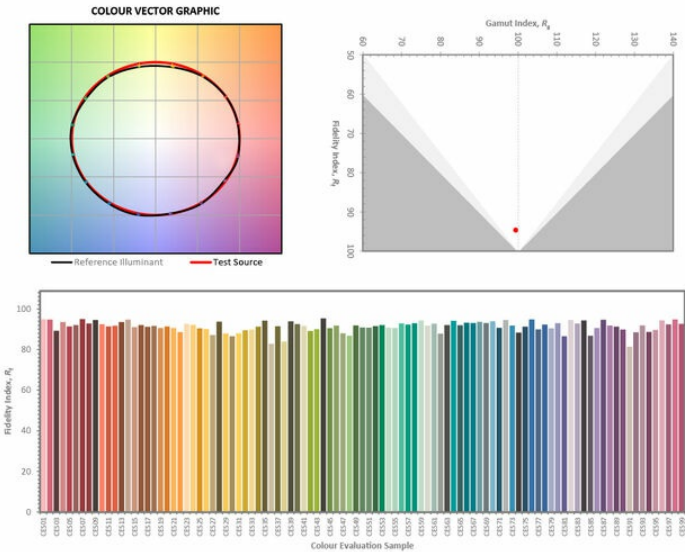

WWW.JOHN CULLEN LIGHTING.COM

UK +44 (0) 20 7371 9000 | Middle East & APAC +971 (0) 4 321 114 | Europe +33 (0)9 61 68 22 81

