

VORSA TRACK 40 SUPER WIDE BLACK 0-10V
2024
SLVT4SW025AN2

LUMINAIRE REF:

PROJECT REF:



BLACK RAL 9005

The updated Vorsa Track 40 is a versatile mini "click and fit" track-mounted directional spotlight. It has been re-engineered for 2024 with a cleaner aesthetic, an increased light output and an industry-leading light output at 98 CRI. Interchangeable optics allow for a range of beam distributions, all easy to fit on-site. Its track architecture facilitates easy changing between different size Vorsa heads when commissioning a scheme. We have introduced a new innovative screwless self-supporting tilt mechanism. This fitting is ideal for use in areas of key areas of the home and is perfect for use on beams and concrete ceilings where recessed fittings are unsuitable. The Vorsa Track 40 can be used on a range of Stucchi track systems including recessed, surface mounted and suspended. Please ask for full details. The range has been built to the principles of the circular economy to not only maximise resources but also to reduce waste and environmental impact.

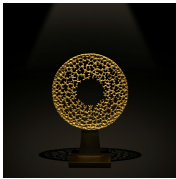
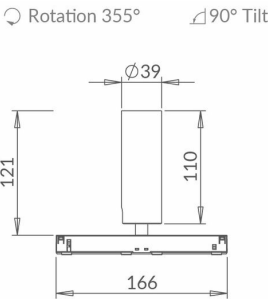

SUPER WIDE

ACCESSORIES

							
VORSA 40 HONEYCOMB INSERT Ø33MM X 3MM ACHCVO402	VORSA 40 SAND BLASTED GLASS INSERT Ø33MM X 3MM ACSGVO402	VORSA 40 HIGH TRANSMISSION SOFTENING GLASS INSERT Ø33MM X 3MM ACSLVO402	VORSA STANDARD EVO TRACK WHITE - 1M/2M SLVTF1012/2012	VORSA STANDARD EVO TRACK BLACK - 1M/2M SLVTF1022/2022	VORSA RECESSED EVO TRACK BLACK - 1M/2M SLVTR1022/2022	VORSA SUSPENDED TRACK WHITE - 1M/2M SLVTW1012/2012	VORSA SUSPENDED TRACK BLACK - 1M/2M SLVTW1022/2022



VORSA TRACK 40 SUPER WIDE BLACK 0-10V
2024
SLVT4SW025AN2

LUMINAIRE REF:

PROJECT REF:

SPECIFICATION	SUPER WIDE
BEAM ANGLE (°)	53°
LED SOURCE LUMENS (LM)	680
LUMINAIRE LUMENS (LM)	470
INTENSITY RATING (CD)	650
POWER CONSUMPTION (W)	9
LUMINAIRE EFFICACY (LM/W)	52
DRIVE CURRENT (mA)	N/A
FORWARD VOLTAGE (V DC)	N/A

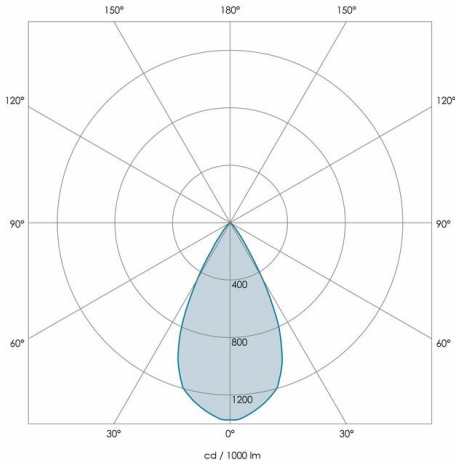

TM66	2.3 (LIA Assured Verification Score)
INGRESS RATING	IP20
IMPACT RATING	IK03
COMPLIANCE	IEC 60598-1:2020
	IEC 60598-2-1:2020

COLOUR TEMPERATURE	2700K
CIE CRI AVAILABLE AS	>95 Ra
IES TM-30 COLOUR FIDELITY (Rf)	>95
IES TM-30 COLOUR GAMUT (Rg)	≈100
BINNING	2-step
LIFETIME L70/B10 (HOURS)	>50000
AMBIENT TEMPERATURE (Ta)	-20 ... +25 °C

ELECTRICAL	
SOURCE TYPE	LED
PRODUCT CLASS	Class III (SELV low voltage)
DIMMING PROTOCOL	0-10V dimmable

OTHER DATA	
CABLE TYPE	FEP (200 °C)
CABLE SIZE	N/A
CABLE LENGTH	N/A
CONNECTOR TYPE	Track Adapter
WEIGHT	250
FIRE RATED	N/A

