

VORSA FIX 50 SUPER WIDE BLACK 2024
SLVF5SW025

LUMINAIRE REF:

PROJECT REF:



BLACK RAL 9005

The new Vorsa Fix 50 spotlight is a surface-mounted directional spotlight. It has been re-engineered for 2024 with a cleaner aesthetic, an increased light output and an industry-leading light output at 98 CRI. Interchangeable optics allow for a range of beam distributions, all easy to fit on-site. We have introduced a new innovative screwless self-supporting tilt mechanism. It is perfect for use on beams and concrete ceilings where recessed fittings are unsuitable. This small spotlight is discreet and easy to direct the light where required. The fitting has a deep baffle which ensures that glare is minimised. The range has been built to the principles of the circular economy to not only maximise resources but also to reduce waste and environmental impact.

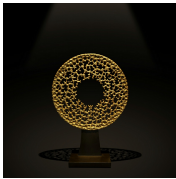
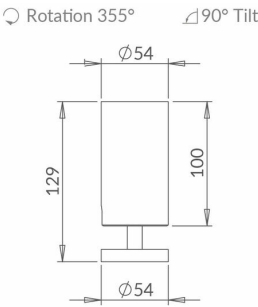

SUPER WIDE

ACCESSORIES

- 

VORSA 50
HONEYCOMB
INSERT Ø48MM X
3MM
ACHCVO502
- 

VORSA 50 SAND
BLASTED GLASS
INSERT Ø48MM X
3MM
ACSGVO502
- 

VORSA 50 HIGH
TRANSMISSION
SOFTENING GLASS
INSERT Ø48MM X
3MM
ACSLVO502



VORSA FIX 50 SUPER WIDE BLACK 2024
SLVF5SW025

LUMINAIRE REF:

PROJECT REF:

SPECIFICATION	SUPER WIDE
BEAM ANGLE (°)	50°
LED SOURCE LUMENS (LM)	1290
LUMINAIRE LUMENS (LM)	780
INTENSITY RATING (CD)	1310
POWER CONSUMPTION (W)	12
LUMINAIRE EFFICACY (LM/W)	65
DRIVE CURRENT (mA)	350
FORWARD VOLTAGE (V DC)	37

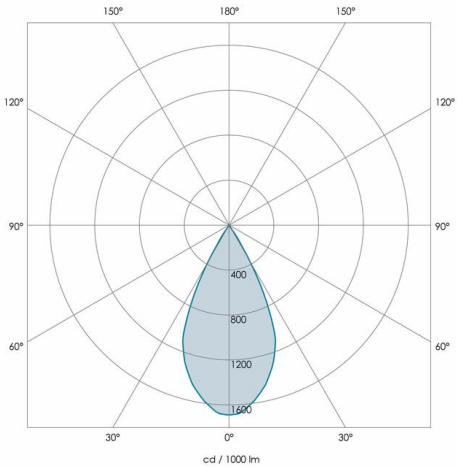

TM66	2.3 (LIA Assured Verification Score)
INGRESS RATING	IP20
IMPACT RATING	IK03
COMPLIANCE	IEC 60598-1:2020
	IEC 60598-2-1:2020

COLOUR TEMPERATURE	2700K
CIE CRI AVAILABLE AS	>95 Ra
IES TM-30 COLOUR FIDELITY (Rf)	>95
IES TM-30 COLOUR GAMUT (Rg)	≈100
BINNING	2-step
LIFETIME L70/B10 (HOURS)	>50000
AMBIENT TEMPERATURE (Ta)	-20 ... +25 °C

ELECTRICAL	
SOURCE TYPE	LED
PRODUCT CLASS	Class III (SELV low voltage)
DIMMING PROTOCOL	0-10V dimmable
	DALI dimmable
	Mains dimmable (phase cut dimming)
	Switched

OTHER DATA	
CABLE TYPE	FEP (200 °C)
CABLE SIZE	2 off 22AWG 19/0.15 (0.15mm ²)
CABLE LENGTH	150
CONNECTOR TYPE	Leads included
WEIGHT	380
FIRE RATED	N/A

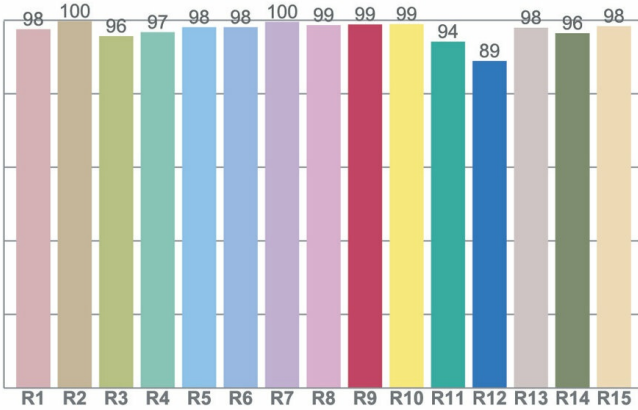
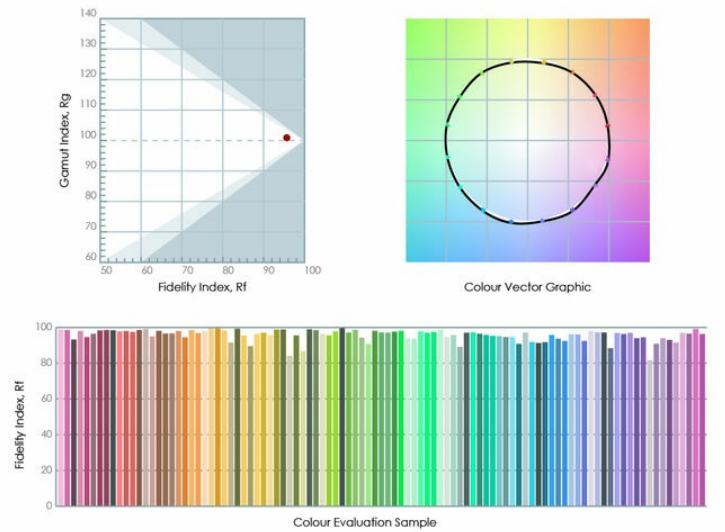

WWW.JOHN CULLEN LIGHTING.COM

UK +44 (0) 20 7371 9000 | Middle East & APAC +971 (0) 4 321 114 | Europe +33 (0)9 61 68 22 81

