

KEW 25 SURFACE
MINIATURE SURFACE-MOUNTED ADJUSTABLE SPOTLIGHT

LUMINAIRE REF:

PROJECT REF:



The Kew 25 Surface is a miniature surface mounted IP66 spotlight, ideal for pinpointing landscape ornaments from above or wall grazing for use both inside and out. Our unique, patented wall mounting system allows for quick, tool-free installation on site. The luminaire mounts onto the wall bracket and is self-locking at 15° intervals, preventing the need for further fixing. A discreet, optional tamper proofing feature is available if required for commercial projects. The Kew Surface is IP66 Rated - see FAQs for more details on IP Values.



BLACK RAL 9005



BRONZE RAL 8019

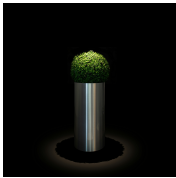
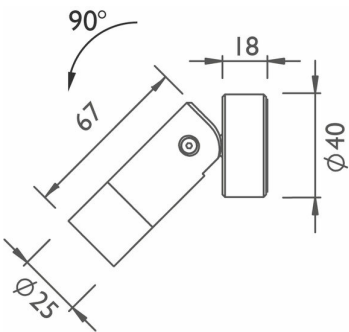

NARROW

ACCESSORIES



IP66 ENCLOSURE
FOR DRIVER
LARGE
ACENIPLRG



IP66 ENCLOSURE
FOR DRIVER
SMALL
ACENIPSMML



KEW/HAMPTON
40 CONDUIT BOX
ACHK4CB1



KEW 25 CAP
SNOOT BLACK
ACK2CS021



KEW 25 CAP
SNOOT BRONZE
ACK2CS061



KEW 25 FULL
SNOOT BLACK
ACK2FS021



KEW 25 FULL
SNOOT BRONZE
ACK2FS061



KEW 25 HALF
SNOOT BLACK
ACK2HS021



KEW 25 HALF
SNOOT BRONZE
ACK2HS061



KEW 25 SHORT
SNOOT BLACK
ACK2SS021



KEW 25 SHORT
SNOOT BRONZE
ACK2SS061



WWW.JOHN CULLEN LIGHTING.COM

UK +44 (0) 20 7371 9000 | Middle East & APAC +971 (0) 4 321 114 | Europe +33 (0)9 61 68 22 81



KEW 25 SURFACE
MINIATURE SURFACE-MOUNTED ADJUSTABLE SPOTLIGHT

LUMINAIRE REF:

PROJECT REF:

SPECIFICATION	NARROW	MEDIUM	WIDE
BEAM ANGLE (°)	11°	22°	30°
LED SOURCE LUMENS (LM)	139	139	139
LUMINAIRE LUMENS (LM)	94	93	85
INTENSITY RATING (CD)	1349	479	263
POWER CONSUMPTION (W)	1.5	1.5	1.5
LUMINAIRE EFFICACY (LM/W)	62	62	57
DRIVE CURRENT (mA)	N/A	N/A	N/A
FORWARD VOLTAGE (V DC)	3	3	3

INGRESS RATING	IP66
IMPACT RATING	N/A
COMPLIANCE	BS EN IEC 60598-1:2014
	IEC 60598-2-7:1982/AMD1:1987/AMD2:1994

COLOUR TEMPERATURE	2700K
CIE CRI AVAILABLE AS	98 Ra
IES TM-30 COLOUR FIDELITY (Rf)	94.3
IES TM-30 COLOUR GAMUT (Rg)	98.1
BINNING	2 SDCM (Equivalent)
LIFETIME L70/B10 (HOURS)	>50000
AMBIENT TEMPERATURE (Ta)	-20 ... +40 °C

ELECTRICAL	
SOURCE TYPE	LED
PRODUCT CLASS	Class III (SELV low voltage)
DIMMING PROTOCOL	DALI dimmable
	1-10V dimmable
	Mains dimmable (phase cut dimming)
	Switched

OTHER DATA	
CABLE TYPE	2 Core Silicone (180°C)
CABLE SIZE	6.4mm OD - 2 off 24/0.2 (0.75mm2)
CABLE LENGTH	350mm
CONNECTOR TYPE	N/A
WEIGHT	55g
FIRE RATED	N/A

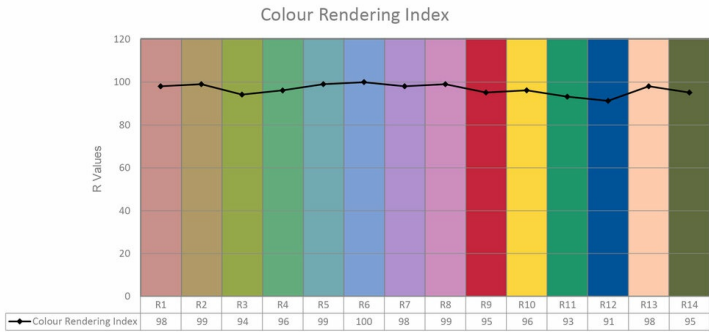
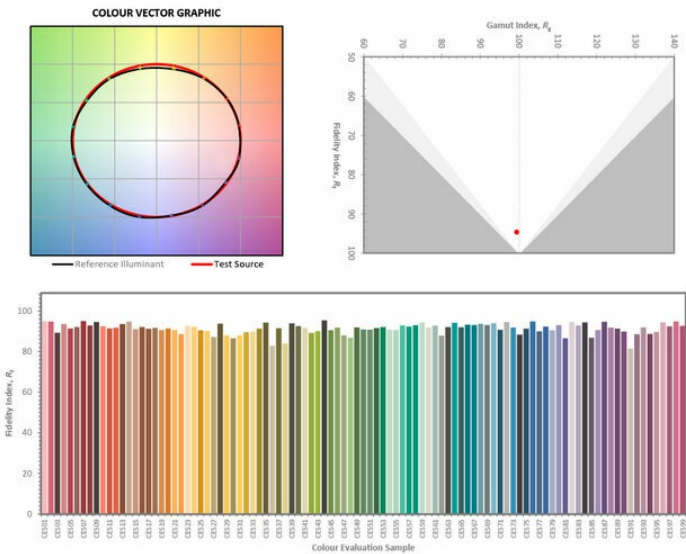

WWW.JOHN CULLEN LIGHTING.COM

UK +44 (0) 20 7371 9000 | Middle East & APAC +971 (0) 4 321 114 | Europe +33 (0)9 61 68 22 81

